

IDEAL SHIELD
CORED ONE LINE STANDARD DROP IN GUARDRAIL
PART#: SGR-1-LENGTH-HEIGHT-CORED

ONE LINE STANDARD GUARDRAIL SIZE CHART		
STANDARD LENGTH (A)	STANDARD HEIGHT (B)	POST TO POST LENGTH (C)
4'-0"	14.75", 27"	2'-0"
6'-0"	14.75", 27"	3'-0"
8'-0"	14.75", 27"	4'-0"
10'-0"	14.75", 27"	5'-0"
12'-0"	14.75", 27"	6'-0"
CUSTOM	CUSTOM - LOWER THAN 27"	(C)=(A)/2

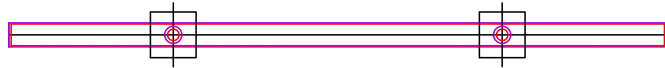

TOP VIEW

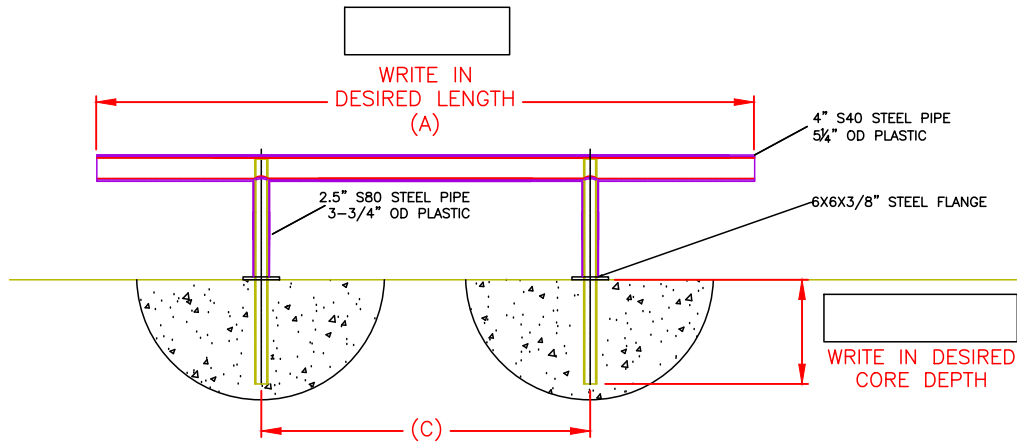

FRONT VIEW

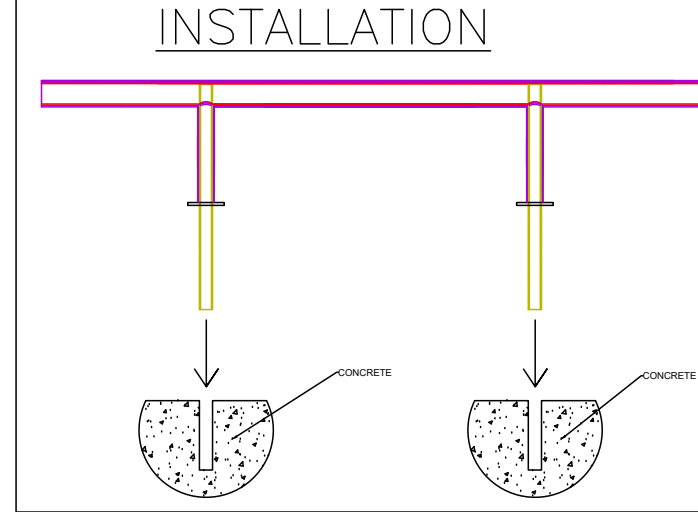

EASY INSTALLATION:
FOR INSTALLATION CORE 6"-8"
INTO CONCRETE (TYPICALLY
DEPTH OF CONCRETE) WITH
2 7/8" DRILL BIT AND DROP IN
PRODUCT

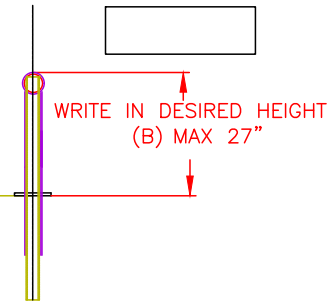

SIDE VIEW

SPECIAL INSTRUCTIONS:

qty.

THIS DRAWING AND ALL THE INFORMATION THEREON IS THE PROPERTY OF THE IDEAL SHIELD. IS CONFIDENTIAL AND MUST NOT BE MADE PUBLIC. NOR COPIED, NOR USED, TO THE DISADVANTAGE OF SAID IDEAL SHIELD AND IS SUBJECT TO RETURN ON DEMAND.

COPYRIGHT 2003 IDEAL SHIELD

NO.	REVISIONS	DATE	APPROVED



2525 Clark St.
Detroit, MI 48209

PROJECT	CUSTOMER	DESCRIPTION	DRAWN BY	APPROVED BY	DATE
		IDEAL SHIELD STANDARD GUARDRAIL DROP IN CORED	DP		
			PROJECT NO. -		SCALE
			TITLE		DRAWING NO.
			MATERIAL: STEEL & HDPE PLASTIC		SHEET 1 OF 1