

GOAL POST GUARDRAIL SPECS

Product Details:

Steel Pipe: Posts are constructed of 6" schedule 40 steel; horizontal rail is constructed of 4" schedule 40 steel

Plastic Sleeve: Posts and rails are sleeved in high-density polyethylene thermoplastic with 0.25" nominal thickness.

Color: OSHA yellow

Shipped: All goal posts are shipped in [3] pieces.

Assembly: 3 people required

Standard Goal Post Sizes:

Width: 8', 10', 12', 14', 16'

Height: 8', 10', 12', 14', 16'

Max Goal Post Size: 20' x 20'

*All measurements are inside dimensions unless otherwise specified.

Part Number	Description	Width	Height	Lbs
GP-096-096	GP-096-096-P	96"	96"	600
GP-120-120	GP-120-120-P	120"	120"	726
GP-144-144	GP-144-144-P	144"	144"	852
GP-168-168	GP-168-168-P	168"	168"	1104

Plated Specs:

Standard Base Plate: 12" x 12" x 3/4"

[4] 15/16" anchor bolt holes

Anchors not provided

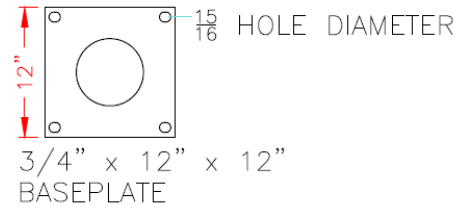

Embedded Specs:

Top Plate: 3/4" Thick x 18" Wide

Bottom Plate: 1/2" Thick x 12" Wide

Overall Height: 6.25" Tall

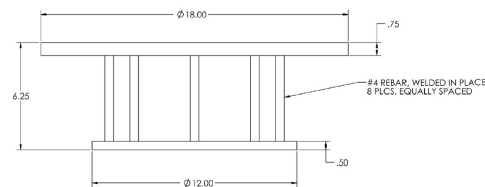

Cored Specs:

Core is recommended to be at least 24" deep

Optional 7" steel floor sleeve, which makes the unit removable

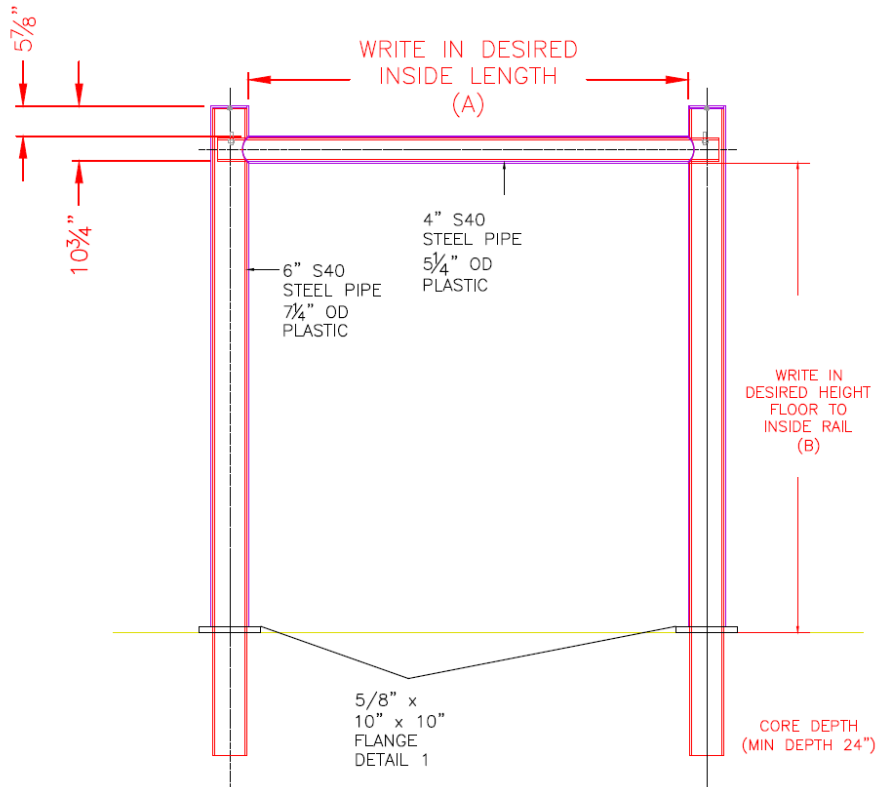

[866]825-8659

WWW.IDEALSHIELD.COM